

# PRODUCT DATA SHEET

DAB-DP251M • 701510

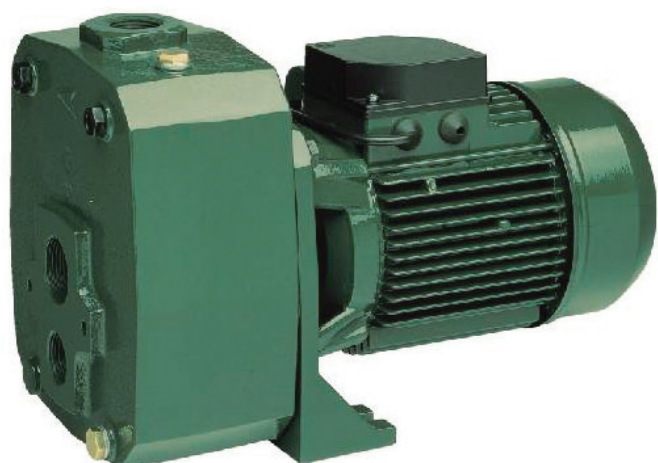

## PRODUCT DETAILS

The pump is a self-priming surface mounted deep well pump and has a suction capability of up to 27m with separately supplied injector kit.

## APPLICATIONS

- Domestic installations where a suction lift is required
- Pressure boosting, irrigation and wash down
- Designed for pumping from wells and from rivers and dams using offset.

## FEATURES

- 240V single phase TEFC motor with in-built auto reset thermal overload to prevent pump from damage

BRAND



## TECHNICAL DATA

### MATERIALS IN CONTACT WITH DRINKING WATER

#### PUMP

PUMP BODY	GJL 200 Cast Iron
IMPELLER	Glass reinforced Noryl
JET, VENTURI, DIFFUSER	Glass reinforced Noryl
MECHANICAL SEAL	Carbon Ceramic Nitrile
O RINGS	Nitrile

### SPECIFICATIONS

RATED POWER (KW)	1.85 (2.5hp)
MAX. FLOW [LPM]	72
MAX. HEAD [M]	70
PORTS	32mm x 25mm (1-1/4"x1")BSP
VOLTS (V)	240
CARTON DIMENSIONS	522mm L x 246mm W x 307mm H
WEIGHT (KG)	32.5

## PERFORMANCE

HYDRAULIC DATA (n ≈ 2800 1/min.)										
TYPE PUMP	TYPE EJECTOR	DEEP SUCTION	Discharge pressure in bar							
			3	3.5	4	4.5	5	5.5	6	6.5
			Capacity table in l/h							
DP 251 M - T	E 20	9	4300	3600	2900	2180	1400	640	-	-
		12	3750	3140	2540	1700	940	-	-	-
		15	-	2780	2040	1300	500	-	-	-
		18	-	2340	1610	820	-	-	-	-
	E 25	15	-	2920	2400	1900	1400	950	570	-
		18	-	2600	2110	1620	1150	720	360	-
		21	-	2350	1850	1350	900	510	-	-
		24	-	2050	1550	1080	660	300	-	-
	E 30	21	-	-	1710	1480	1220	980	770	590
		24	-	-	1580	1330	1080	850	670	490
		27	-	-	1440	1200	950	750	560	400
		30	-	-	-	-	-	-	-	-
	E 35	18	-	-	-	-	-	-	-	-
		21	-	-	-	-	-	-	-	-
		24	-	-	-	-	-	-	-	-
		27	-	-	-	-	-	-	-	-

## DIMENSIONS

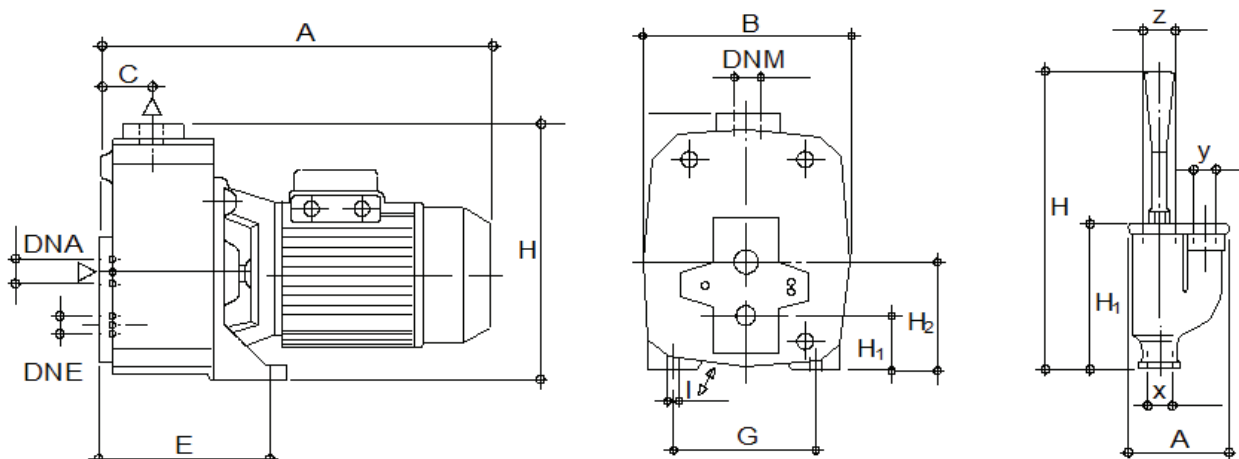

MODEL	A	B	C	DNA GAS	DNE GAS	DNM GAS	E	G	H	H1	H2	I Ø	x	y	z
DAB-251	388	210	50	1" ¼	1"	1"	197	145	255	53	108	11	1"G	1"G	1"¼ G

## WARRANTY / CERTIFICATIONS

