



Position	Qty.	Description
----------	------	-------------

1

**CMBE 1-44 AVBE**



**Note! Product picture may differ from actual product**

Product No.: [98374679](#)

The Grundfos CME Booster is a compact booster system for water supply in domestic applications. The integrated speed controller enables the CME Booster to keep constant pressure in the pipe system. A pressure sensor monitoring changes in the water consumption will signal to the speed controller to change the motor speed to adapt performance to the new state.

The CME Booster is very easy to install. When the pipework has been installed, it is all a matter of plugging the unit into a socket, and the system is operational.

The CME Booster consists of:

- CME pump with integrated frequency converter
- 5-way valve
- expansion tank
- pressure gauge
- manometer

**Features**

- Constant pressure, integrated speed control
- compact
- robust, stainless steel
- easy installation
- dry run protection

**Thermal protection**

CME Booster pumps require no external motor protection.

The MGE motor incorporates thermal protection against slow overloading and blocking (IEC 34.11: TP 211).

**Liquid:**

Pumped liquid: Water  
 Liquid temperature range: 0 .. 60 °C  
 Liquid temp: 20 °C  
 Density: 998.2 kg/m<sup>3</sup>





## 98374679 CMBE 1-44 50 Hz

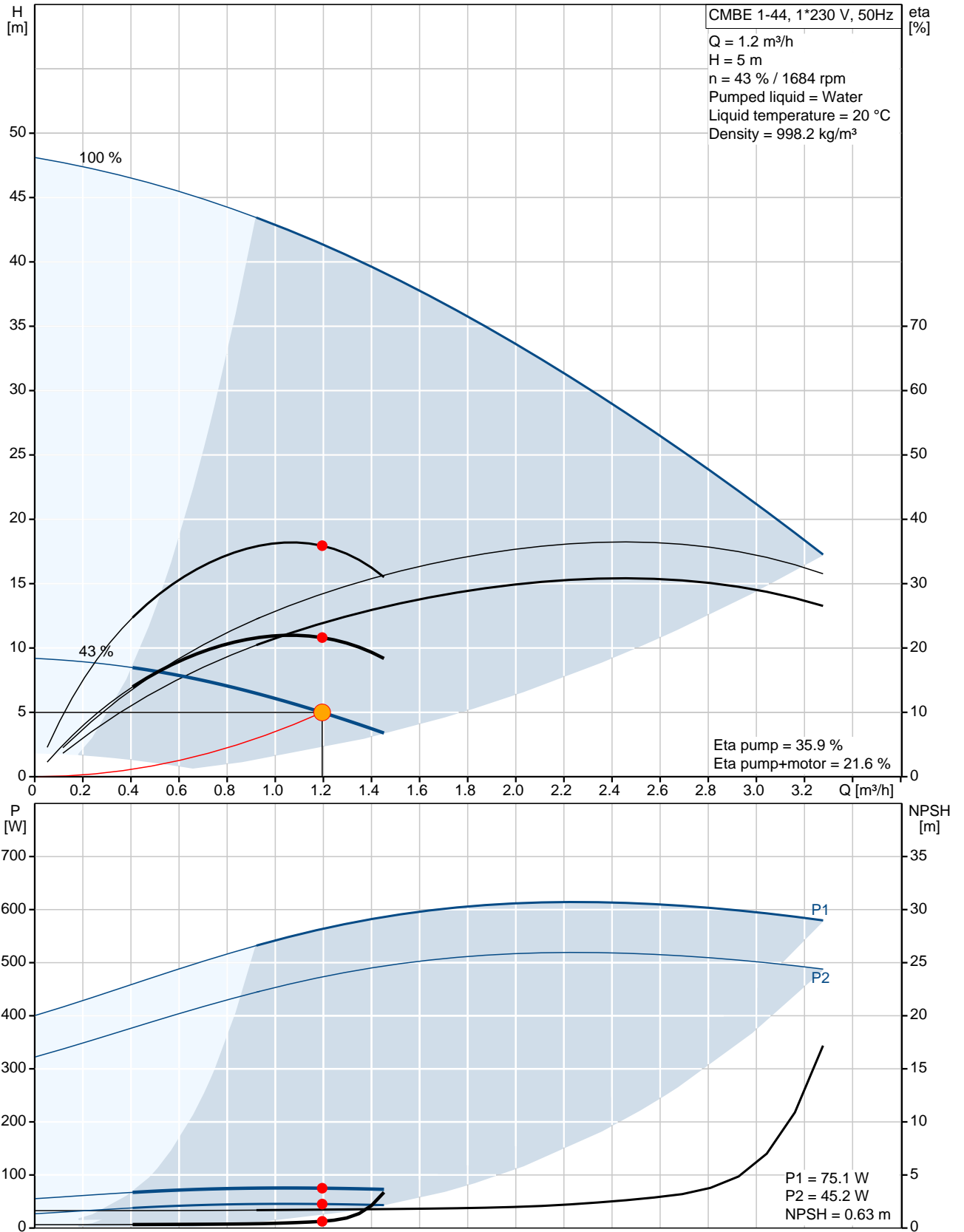

Description	Value
<b>General information:</b>	
Product name:	CMBE 1-44 AVBE
Position:	
Product No:	98374679
EAN number:	5711493909194
Price:	On request
<b>Technical:</b>	
Speed for pump data:	3776 rpm
Rated flow:	2 m³/h
Rated head:	26.2 m
Impellers:	3
Shaft seal:	AVBE
Approvals and markings:	CE
Curve tolerance:	ISO 9906:2012 Grade 3B
Model:	A
Start pressure:	Integrated Frequency converter
<b>Materials:</b>	
Pump housing:	Stainless steel DIN W.-Nr. 1.4301 AISI 304
Impeller:	Stainless steel DIN W.-Nr. 1.4301 AISI 304
Rubber:	EPDM
<b>Installation:</b>	
Maximum ambient temperature:	55 °C
Flange standard:	WHITWORTH THREAD RP
Pump inlet:	Rp 1
Pump outlet:	Rp 1
<b>Liquid:</b>	
Liquid temperature range:	0 .. 60 °C
Kinematic viscosity:	1 mm²/s
<b>Electrical data:</b>	
Maximum current consumption:	3,45-2,90 A
Rated power - P2:	0.55 kW
Mains frequency:	50 Hz
Rated voltage:	1 x 200-240 V
p max system:	10 bar
Rated speed:	360-4000 rpm
Enclosure class (IEC 34-5):	IP55
Insulation class (IEC 85):	F
Type of cable plug:	NONE
Mains cable:	1.5 m
<b>Tank:</b>	
Tank volume:	2 l
<b>Others:</b>	
Net weight:	16.1 kg
Gross weight:	24.6 kg
Config. file no:	98390431

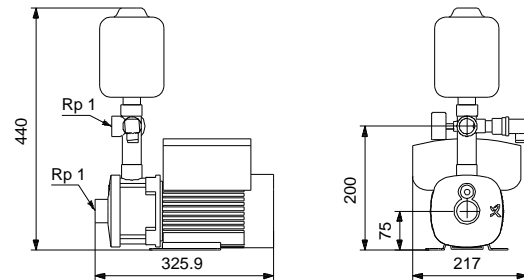
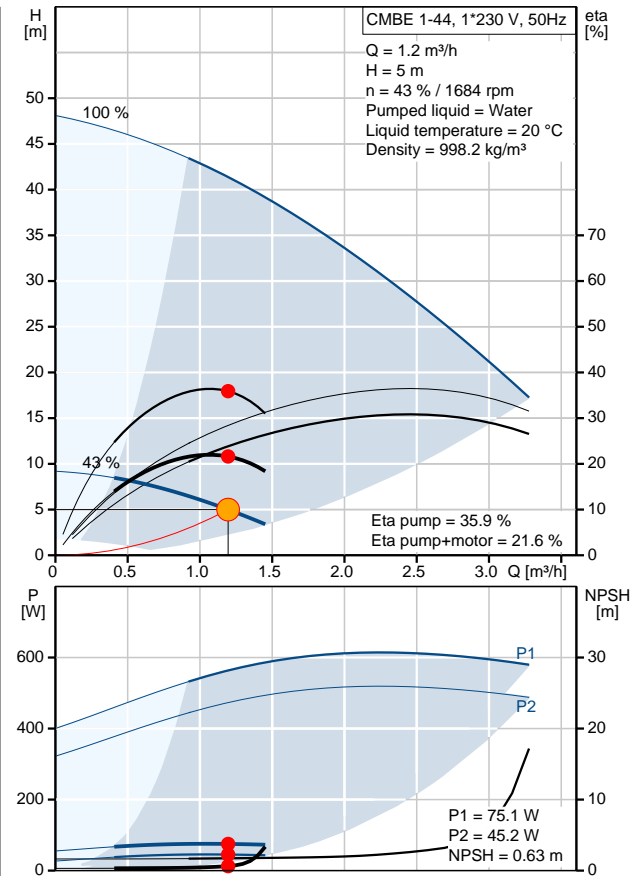



**98374679 CMBE 1-44 50 Hz**

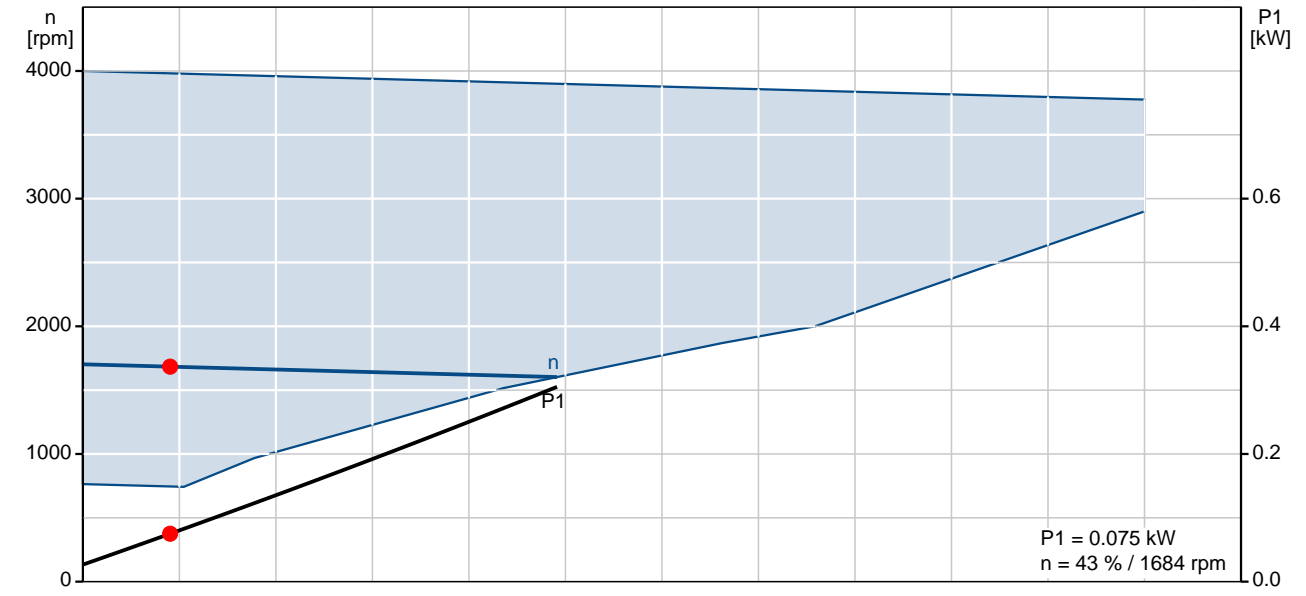
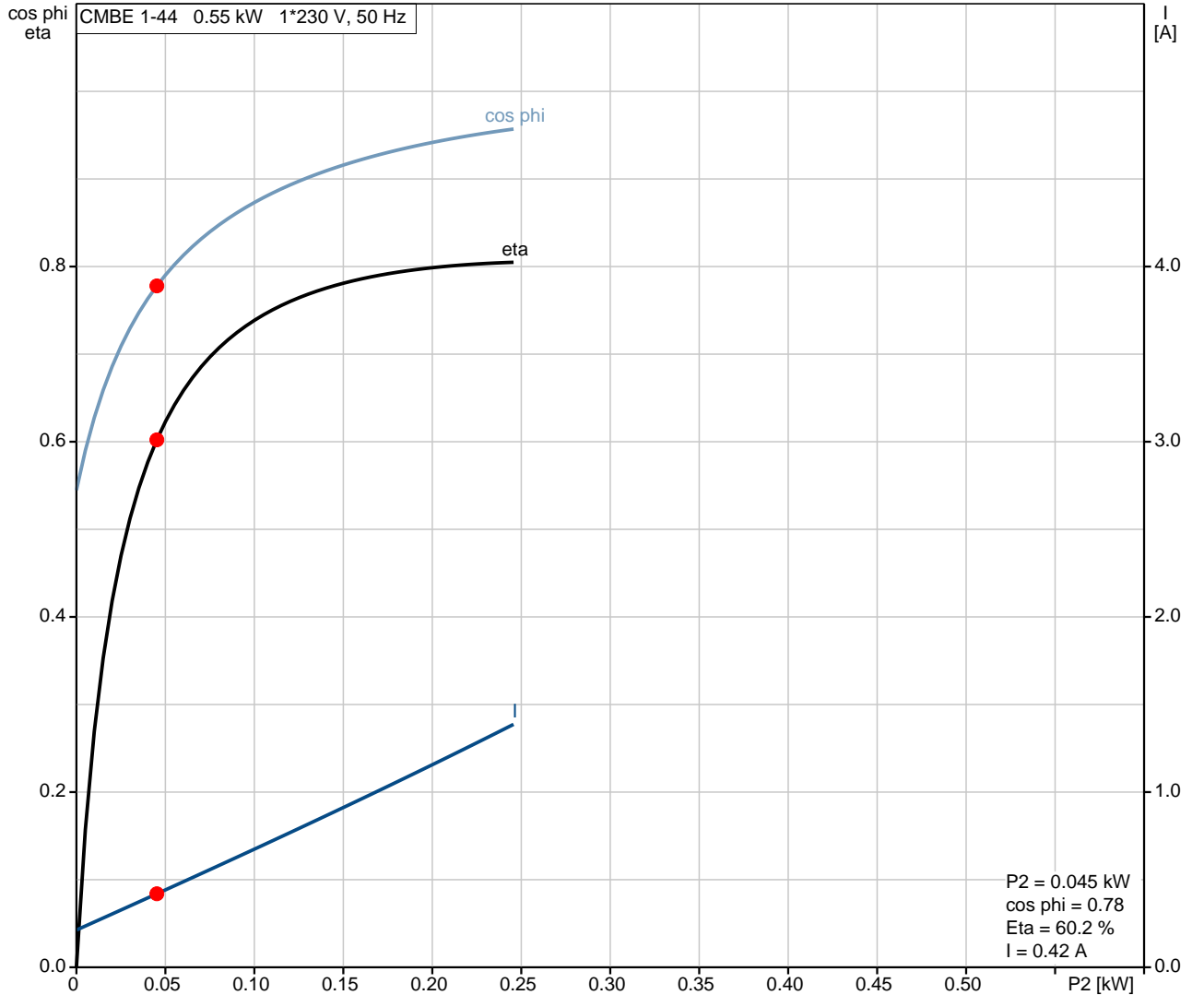



**98374679 CMBE 1-44 50 Hz**

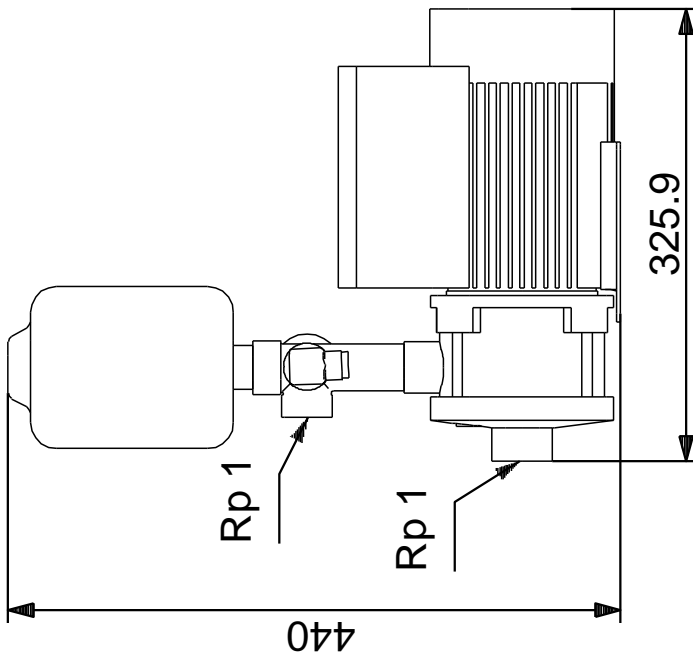
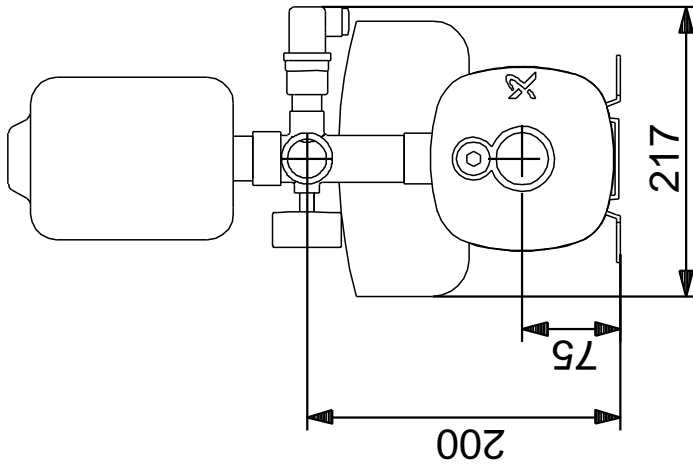

Note! All units are in [mm] unless others are stated.  
Disclaimer: This simplified dimensional drawing does not show all details.